

**MONTGOMERY COUNTY**  
 SECONDARY SEAL  
 REQUEST MAP

040397  
 26-AUG-2015 13:36  
 C:\Users\jmontgomery\Documents\2015\Montgomery-Overview.mxd

MAPS #1 #8 - #12 #14 #15 & #16

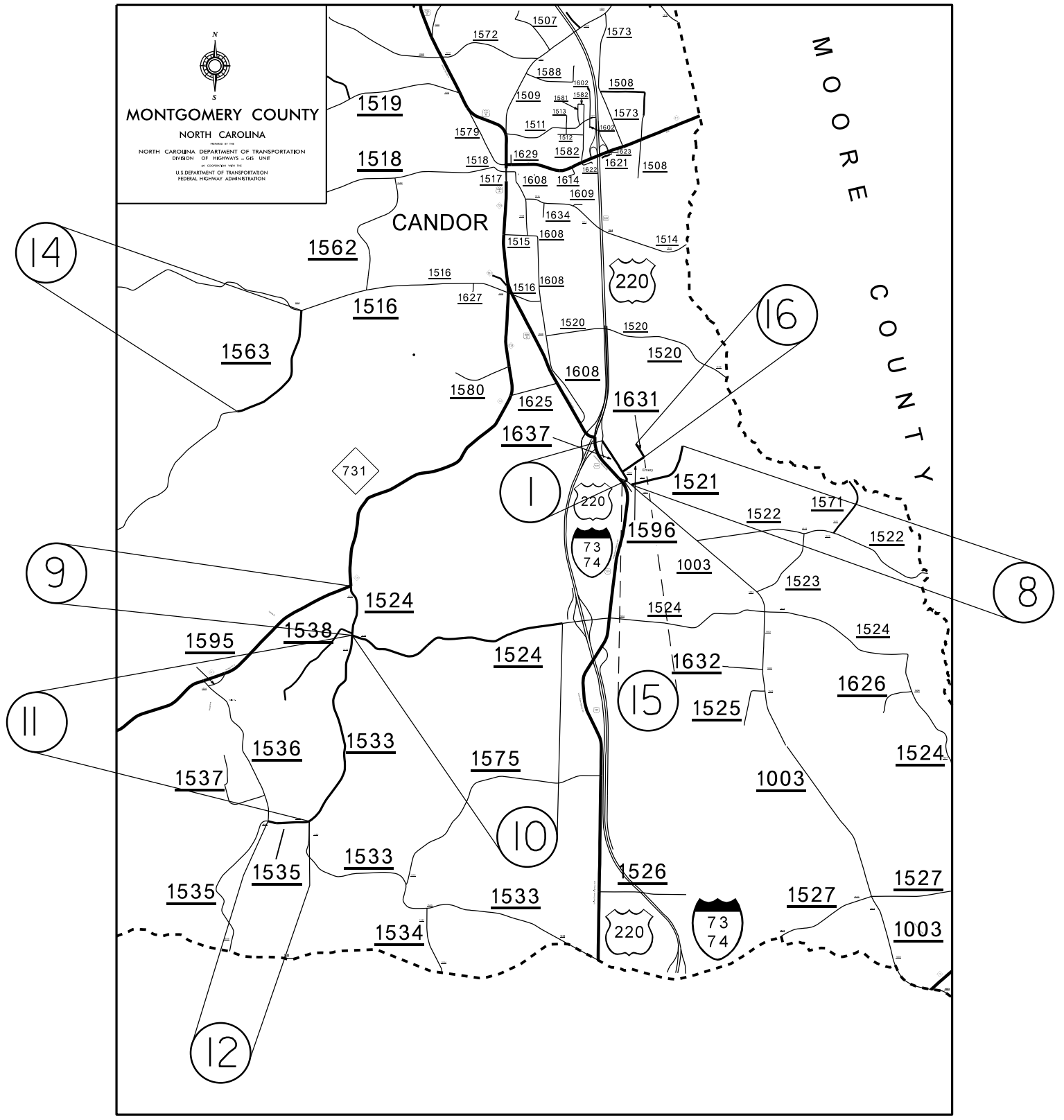

MAPS #2 & #3

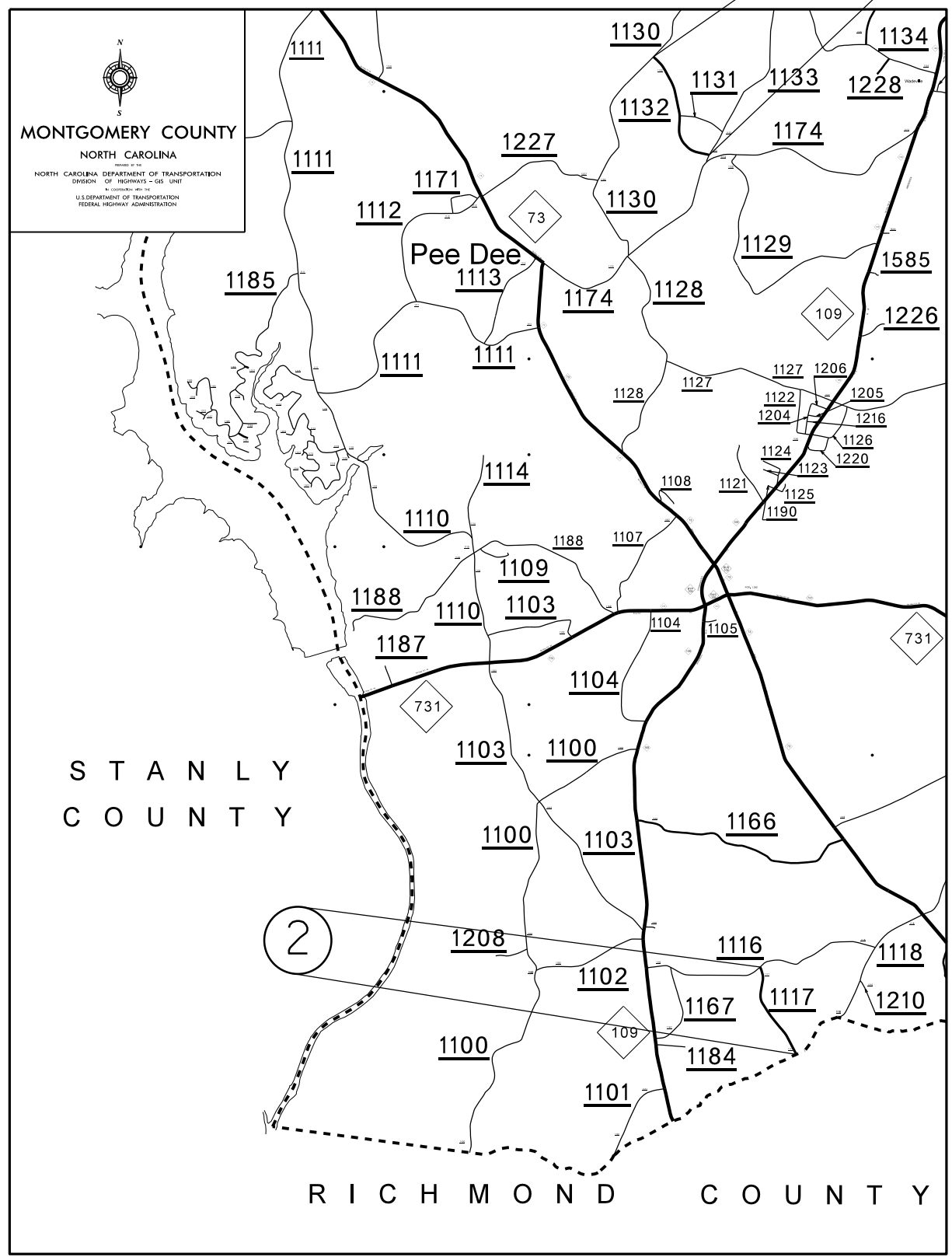

040397  
 26-AUG-2016 13:36  
 I:\Content\2015\2015\_Summer\_Montgomery\_Seal\_Vivint.dgn



# MAP #13

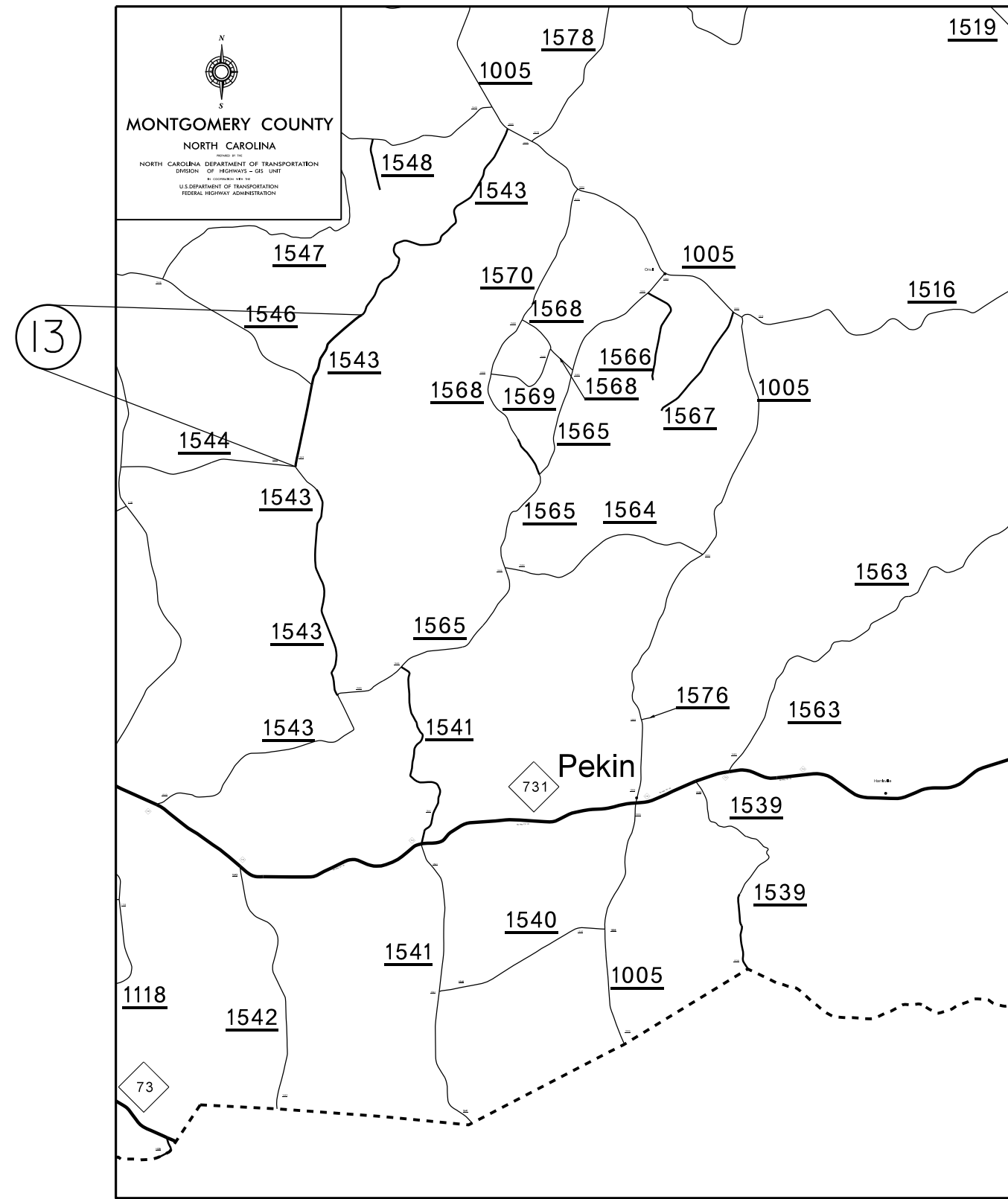

040397

26-AUG-2016 13:36  
 I:\Content\2015\2015\_Summer\_2015\2015\_Summer\_Montgomery\_Seal\_Vivint.dgn

PROJECT NO.	SHEET NO.	TOTAL NO.
2016CPT.08.07.20622	5	

## SUMMARY OF QUANTITIES

PROJECT NO	COUNTY	MAP NO	ROUTE	DESCRIPTION	LANES	LENGTH MI	WIDTH FT	ASPHALT SURFACE TREATMENT, DOUBLE SEAL SY	EMULSION FOR ASPHALT SURFACE TREATMENT GAL	BLOTTING SAND TON	4413000000-E	4457000000-N	4810000000-E	4810000000-E
											WORK ZONE ADVANCE/GENERAL WARNING SIGNING SF	TEMPORARY TRAFFIC CONTROL LS	4" WHITE PAINT LF	4" YELLOW PAINT LF
2016CPT.08.07.20622	Montgomery	1	SR 1003 (EMERY RD)	FROM SR 1003 (WINDBLOW RD) TO DEAD END	2	0.49	16	4,600.00	2,530		55			
<b>TOTAL FOR MAP NO. 1</b>						<b>0.49</b>		<b>4,600.00</b>	<b>2,530</b>		<b>55</b>			
2016CPT.08.07.20622	Montgomery	2	SR 1117 (HARRIS RD)	FROM RICHMND CO TO SR 1116 (HAITHCOCK RD)	2	0.91	20	10,700.00	5,873		102		19,583	19,583
<b>TOTAL FOR MAP NO. 2</b>						<b>0.91</b>		<b>10,700.00</b>	<b>5,873</b>		<b>102</b>		<b>19,583</b>	<b>19,583</b>
2016CPT.08.07.20622	Montgomery	3	SR 1132 (STONE FORD CHURCH RD)	FROM SR 1133 (DEBERRY RD) TO SR 1130 (APPLE ORCHARD RD)	2	1.138	20	13,355.00	7,344		128		24,490	24,490
<b>TOTAL FOR MAP NO. 3</b>						<b>1.138</b>		<b>13,355.00</b>	<b>7,344</b>		<b>128</b>		<b>24,490</b>	<b>24,490</b>
2016CPT.08.07.20622	Montgomery	4	SR 1134 (OPHIR RD)	FROM SR 1139 (MT CARMEL CHURCH RD) TO NC 109	2	1.78	20	15,140.00	8,325		145		38,306	38,306
<b>TOTAL FOR MAP NO. 4</b>						<b>1.78</b>		<b>15,140.00</b>	<b>8,325</b>		<b>145</b>		<b>38,306</b>	<b>38,306</b>
2016CPT.08.07.20622	Montgomery	5	SR 1135 (BRUTON CEMETARY RD)	FROM SR 1134 (OPHIR RD) TO SR 1136 (BRUTON CARPENTER RD)	2	1.29	20	25,350.00	13,939		245		27,761	27,761
<b>TOTAL FOR MAP NO. 5</b>						<b>1.29</b>		<b>25,350.00</b>	<b>13,939</b>		<b>245</b>		<b>27,761</b>	<b>27,761</b>
2016CPT.08.07.20622	Montgomery	6	SR 1301 (LOW WATER BRIDGE RD)	FROM SR 1134 (OPHIR RD) TO END PVMT	2	1.057	16	9,930.00	5,457		120		22,747	22,747
<b>TOTAL FOR MAP NO. 6</b>						<b>1.057</b>		<b>9,930.00</b>	<b>5,457</b>		<b>120</b>		<b>22,747</b>	<b>22,747</b>
2016CPT.08.07.20622	Montgomery	7	SR 1323 (OKEEWEMEE RD)	FROM EAST JOINT OF BRIDGE 121 TO SR 1340 (OKEEWEMEE RD)	2	1.97	18	29,470.00	16,204		315		42,394	42,394
<b>TOTAL FOR MAP NO. 7</b>						<b>1.97</b>		<b>29,470.00</b>	<b>16,204</b>		<b>315</b>		<b>42,394</b>	<b>42,394</b>
2016CPT.08.07.20622	Montgomery	8	SR 1521 (LIGHTHOUSE CHURCH RD)	FROM SR 1003 (WINDBLOW RD) TO DEAD END	2	0.75	20	8,800.00	4,840		85			
<b>TOTAL FOR MAP NO. 8</b>						<b>0.75</b>		<b>8,800.00</b>	<b>4,840</b>		<b>85</b>			
2016CPT.08.07.20622	Montgomery	9	SR 1524 (TABERNACLE CHURCH RD)	FROM NC 731 TO SR 1533 (CEMETERY RD)	2	0.527	18	5,570.00	3,061		60		11,341	11,341
<b>TOTAL FOR MAP NO. 9</b>						<b>0.527</b>		<b>5,570.00</b>	<b>3,061</b>		<b>60</b>		<b>11,341</b>	<b>11,341</b>
2016CPT.08.07.20622	Montgomery	10	SR 1524 (TABERNACLE CHURCH RD)	FROM SR 1533 (CEMETERY RD) TO PVT JT 850FT W OF I 73/74 RAMP	2	2.29	18	24,190.00	13,300		260		49,281	49,281
<b>TOTAL FOR MAP NO. 10</b>						<b>2.29</b>		<b>24,190.00</b>	<b>13,300</b>		<b>260</b>		<b>49,281</b>	<b>49,281</b>
2016CPT.08.07.20622	Montgomery	11	SR 1533 (CEMETERY RD)	FROM SR 1535 (GRAHAM RD) TO SR 1524 (TABERNACLE CHURCH RD)	2	2.12	20	24,880.00	13,681		240		45,622	45,622
<b>TOTAL FOR MAP NO. 11</b>						<b>2.12</b>		<b>24,880.00</b>	<b>13,681</b>		<b>240</b>		<b>45,622</b>	<b>45,622</b>
2016CPT.08.07.20622	Montgomery	12	SR 1535 (GRAHAM RD)	FROM SR 1536 (DRY CREEK RD) TO SR 1533 (CEMETERY RD)	2	0.43	20	5,050.00	2,775		50		9,254	9,254
<b>TOTAL FOR MAP NO. 12</b>						<b>0.43</b>		<b>5,050.00</b>	<b>2,775</b>		<b>50</b>		<b>9,254</b>	<b>9,254</b>
2016CPT.08.07.20622	Montgomery	13	SR 1543 (PLEASANT GROVE CHURCH RD)	FROM END PVMT 0.85MI N OF SR 1546 SHOE FACTORY RD) TO SR 1544 (CALVARY CHURCH RD)	2	1.66	20	27,230.00	14,972		260		35,723	35,723
<b>TOTAL FOR MAP NO. 13</b>						<b>1.66</b>		<b>27,230.00</b>	<b>14,972</b>		<b>260</b>		<b>35,723</b>	<b>35,723</b>
2016CPT.08.07.20622	Montgomery	14	SR 1563 (LOVIN HILL RD)	FROM END PVMT 1MI S OF SR 1516 TO SR 1516 (MCCALUM RD)	2	0.998	20	11,720.00	6,440		115		21,477	21,477
<b>TOTAL FOR MAP NO. 14</b>						<b>0.998</b>		<b>11,720.00</b>	<b>6,440</b>		<b>115</b>		<b>21,477</b>	<b>21,477</b>
2016CPT.08.07.20622	Montgomery	15	SR 1596 (ROBINSON RD)	FROM SR (1003 EMERY RD) TO SR 1631 (BLAKE ST)	2	0.272	20	3,200.00	1,755		35			
<b>TOTAL FOR MAP NO. 15</b>						<b>0.272</b>		<b>3,200.00</b>	<b>1,755</b>		<b>35</b>			
2016CPT.08.07.20622	Montgomery	16	SR 1631 (BLAKE ST)	FROM SR 1596 (ROBINSON RD) TO END PVMT	2	0.16	20	1,880.00	1,033		20			
<b>TOTAL FOR MAP NO. 16</b>						<b>0.16</b>		<b>1,880.00</b>	<b>1,033</b>	*	<b>20</b>	*		
<b>TOTAL FOR PROJ NO. 2016CPT.08.07.20622</b>						<b>17.842</b>		<b>221,065.00</b>	<b>121,529</b>	<b>25</b>	<b>2,235</b>	<b>1</b>	<b>347,979</b>	<b>347,979</b>
												<b>695,958</b>		
<b>GRAND TOTAL</b>						<b>17.842</b>		<b>221,065.00</b>	<b>121,529</b>	<b>25</b>	<b>2,235</b>	<b>1</b>	<b>347,979</b>	<b>347,979</b>
												<b>695,958</b>		

## SIGNING FOR ASPHALT SURFACE TREATMENT

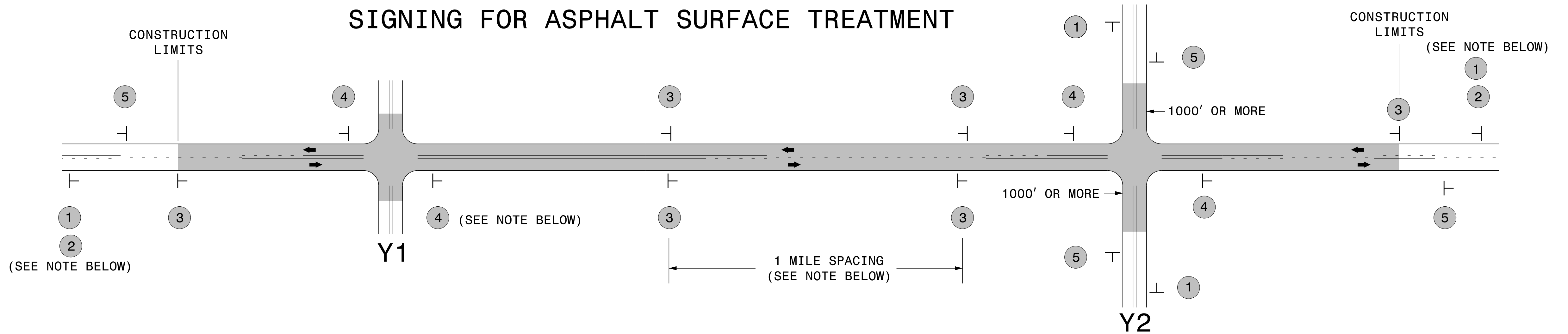

LEGEND	
┆	STATIONARY SIGN
←	DIRECTION OF TRAFFIC FLOW

### MAINLINE (-L-) SIGNING

### -Y- LINE SIGNING

SIGNING NOTES AND PLACEMENT PER DIRECTION	 	<p>PLACE 1000' PRIOR TO BEGINNING OF CONSTRUCTION LIMITS. ONLY USED ON -Y- LINES IF RESURFACING LIMITS EXTEND 1000' ALONG -Y- LINE.</p> <p>#2 SIGN ONLY USED WHEN RESURFACING LIMITS ARE 2 OR MORE MILES IN LENGTH. ROUND UP TO NEXT WHOLE NUMBER. (NO FRACTIONAL OR DECIMAL NUMBERS)</p>	<p><b>NO REQUIRED STATIONARY SIGNING FOR THE FOLLOWING -Y- LINE CONDITIONS:</b></p> <ol style="list-style-type: none"> <li>1) LESS THAN 1000' OF RESURFACING ALONG -Y- LINE</li> <li>2) SUBDIVISION ROADS</li> <li>3) DEAD END ROADS</li> </ol> <p>WHEN PAVING/CONSTRUCTION ACTIVITIES PROCEED ACROSS AN UNSIGNED -Y- LINE, ADVANCE WARNING PORTABLE SIGNS SHALL BE USED ALONG THE -Y- LINE AS SHOWN BELOW. REMOVE UPON COMPLETION OF WORK.</p> <div style="display: flex; justify-content: space-around; align-items: center;"> </div> <p>PLACED 500' IN ADVANCE OF FLAGGER. PLACED 250' IN ADVANCE OF FLAGGER.</p>
	 	<p>ALTERNATE THE FOLLOWING TWO SIGNS:</p> <p>STARTING WITH "LOOSE GRAVEL" (W8-7) FOLLOWED BY "UNMARKED PAVEMENT".</p> <p>PLACE INITIALLY AT THE CONSTRUCTION LIMITS AND SPACED 1 MILE APART THEREAFTER. IF NO -Y- LINES EXIST, PLACE 2ND SET ½ MILE FROM THE CONSTRUCTION LIMITS AND THEN SPACE 1 MILE THEREAFTER.</p>	
		<p>THESE ARE FOR -Y- LINES THAT ARE "THROUGH" ROADWAYS. DEAD END AND SUBDIVISION ROADS ARE NOT "THROUGH" ROADWAYS. INSTALL 500' +/- FROM EACH -Y- LINE APPROACH AS SHOWN ABOVE. FOR MULTIPLE -Y- LINES THAT ARE SEPARATED BY 0.25 MILES OR LESS, TREAT AS A SINGLE UNIT AND INSTALL WITHIN 500' OF EACH APPROACH. A MAXIMUM OF 2 SIGN SETS PER MILE. DO NOT INSTALL WHEN -Y- LINES ARE WITHIN 0.5 MILES FROM "END ROAD WORK" SIGN.</p>	
		<p>PLACE 500' FOLLOWING THE END OF CONSTRUCTION LIMITS.</p>	

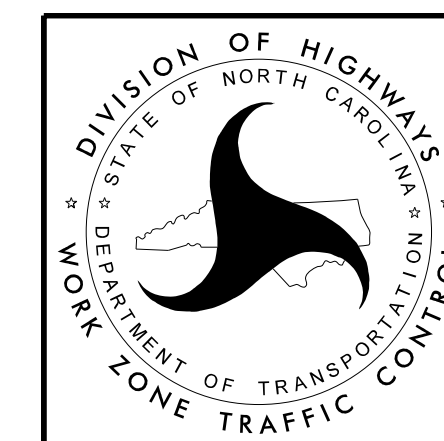

**ADVANCE WARNING SIGNS FOR ASPHALT SURFACE TREATMENTS 2 LANE ROADWAYS**